

Generic Standing Seam Clamp

Ensures a secure, non-penetrating installation with versatile compatibility and support for various orientations.

Application	Generic standing seam sheet profiles
Key Features	Quick installation with two M8 grub screws Rounded set screws protect sheets from damage Versatile M8 center hole supports multiple clamp types Compatible with a contact-preventing insert
Material	Aluminium 6005-T5, Stainless steel SUS304
Product Type	Concealed Fix
Specifications	Anodised > 13 µm
Dimensions	H 45 mm x L 45 mm x W 33 mm
Total Weight	11 g (including fasteners)
Orientation	Solution dependant (landscape and portrait)

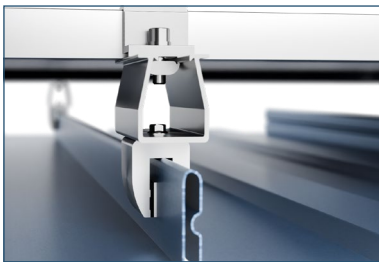
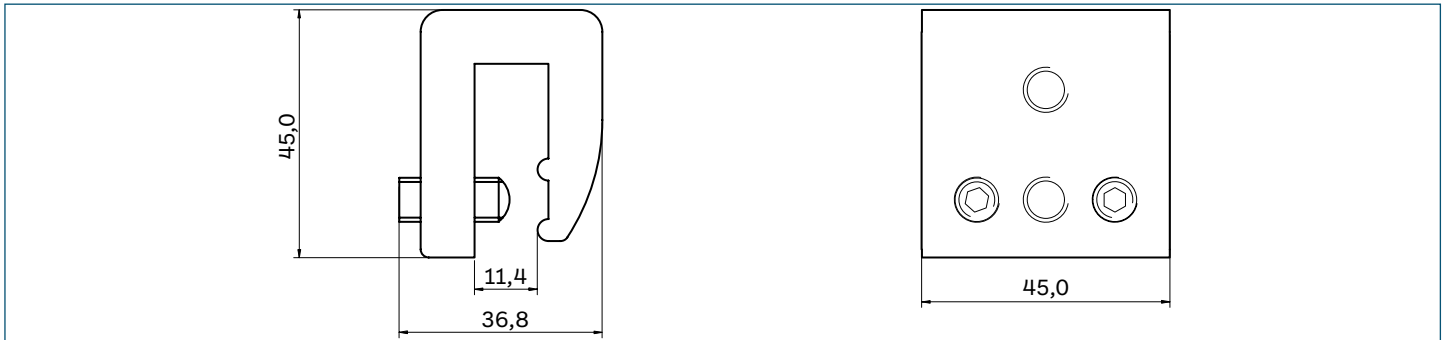

Non-Penetrating

The LM-SSG clamp offers a durable, concealed-fix design that protects your standing seam sheet. Compatible with both landscape and portrait orientations, it ensures a reliable, corrosion-resistant hold.

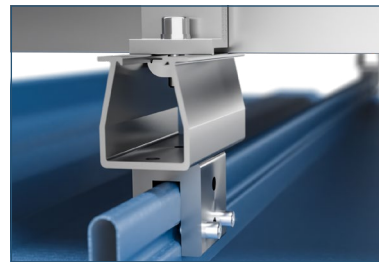

Quick Installation

With two M8 grub screws and rounded set screws, installation is fast and damage-free. Its M8 centre hole enhances compatibility, while the optional contact-preventing insert adds extra protection.